

IRIS/SIMPO Repeater Panel, Model: TFT
Quick Installation Manual

CE 23
1293
DoP No: 138

TELETEK
Teletek Electronics JSC
Address: 2 Iliyansko shose Str,
1220 Sofia, Bulgaria

Enclosure Box

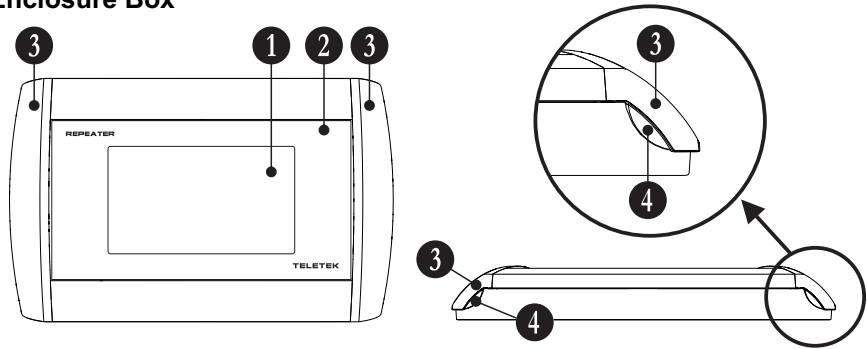

Opening

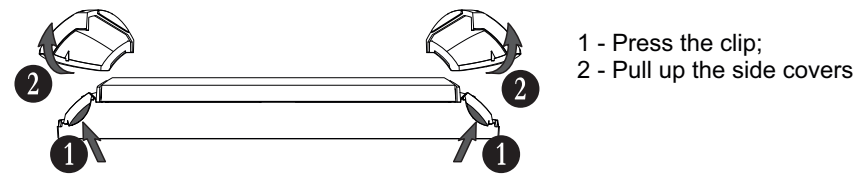

Closing

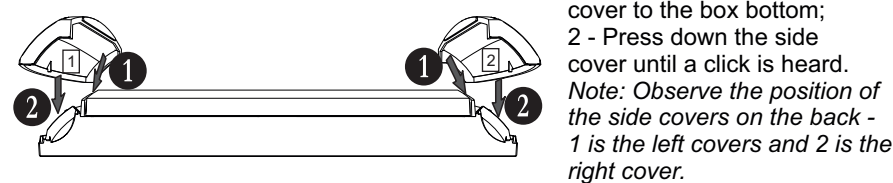

ATTENTION!

Operation with Repeater Panel, model TFT, is supported for the following revisions:

IRIS Fire Alarm Panel

LCD PCB Hardware revision: 2.4 and higher
MAIN Board Firmware revision: 4.2 and higher

SIMPO Fire Alarm Panel

MAIN Board Firmware revision: 2.8 and higher

iRIS4 Fire Alarm Panel

MAIN Board Firmware revision: 1.0 and higher

iRIS8 Fire Alarm Panel

MAIN Board Firmware revision: 1.0 and higher

Removing the front cover

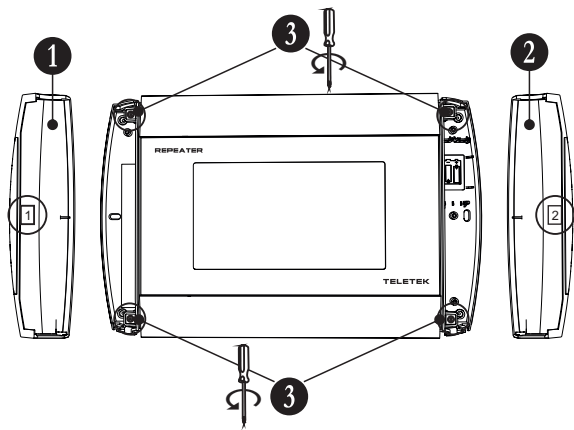

18021097, RevD, 07/2024

IRIS/SIMPO Repeater Panel, Model: TFT
Quick Installation Manual

CE 23
1293
DoP No: 138

TELETEK
Teletek Electronics JSC
Address: 2 Iliyansko shose Str,
1220 Sofia, Bulgaria

Enclosure Box

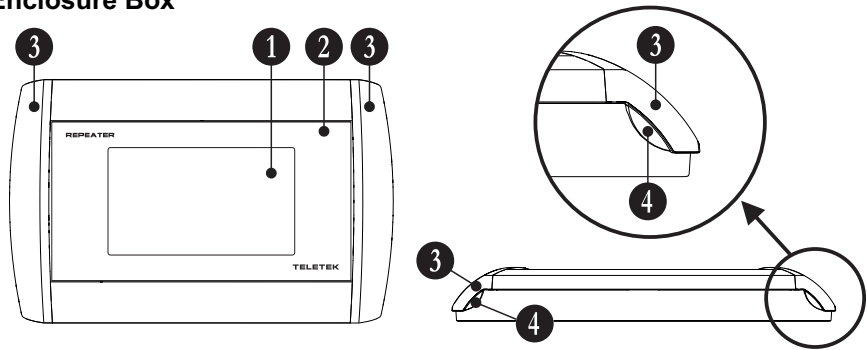

Opening

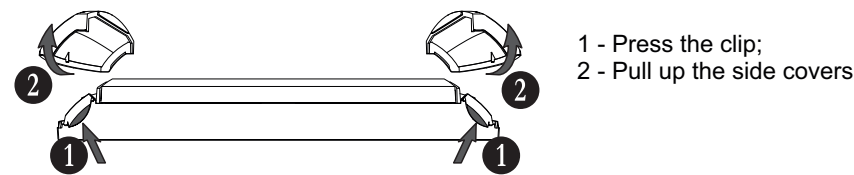

Closing

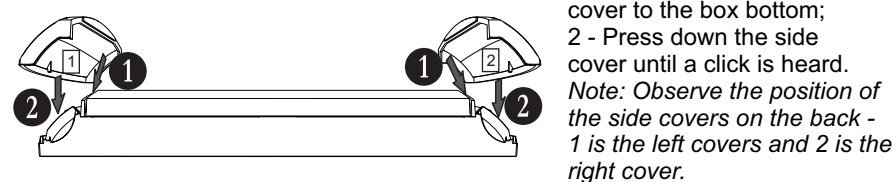

ATTENTION!

Operation with Repeater Panel, model TFT, is supported for the following revisions:

IRIS Fire Alarm Panel

LCD PCB Hardware revision: 2.4 and higher
MAIN Board Firmware revision: 4.2 and higher

SIMPO Fire Alarm Panel

MAIN Board Firmware revision: 2.8 and higher

iRIS4 Fire Alarm Panel

MAIN Board Firmware revision: 1.0 and higher

iRIS8 Fire Alarm Panel

MAIN Board Firmware revision: 1.0 and higher

Removing the front cover

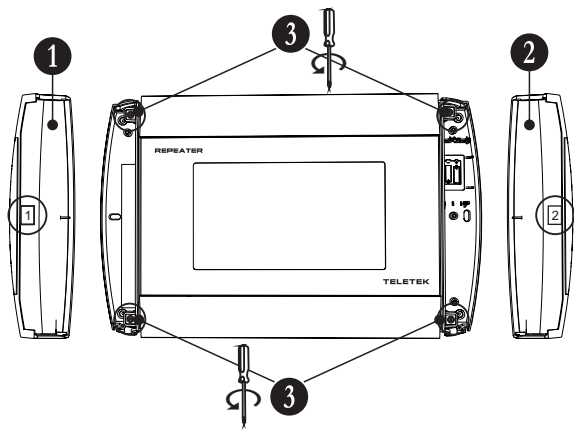

18021097, RevD, 07/2024

PCB Elements

- 1 - 24V DC Power supply
- 2 - RS485 interface
- 3 - LED indication for RS485 interface
 - Normal mode - blinking
 - Trouble mode - lighting on
- 4 - LAN interface
- 5 - USB interface
- 6 - Restore Defaults jumper
- 7 - Built-in battery
 - Jumper BTR must be set.
- 8 - Built-in sound buzzer

Technical Characteristics:

Power Supply: (24 ± 4) VDC
Max. consumption: 300mA
Communication - LAN/RS485

Twisted pair cable:
- Length - max. 1000m
(between repeater - fire panel)
- Cross Section - 0.5 - 2.5mm²

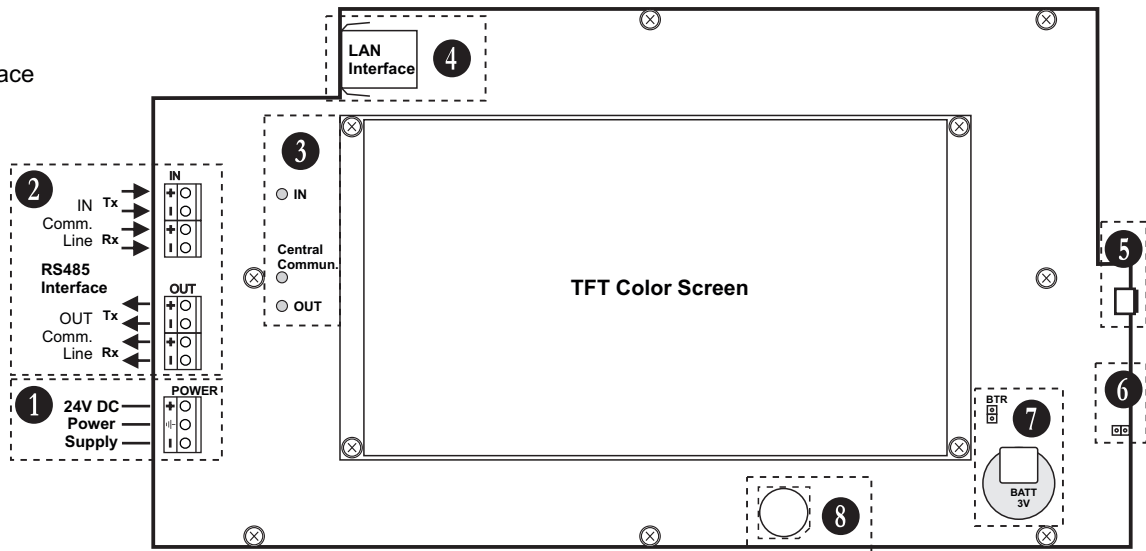

Connection Diagram

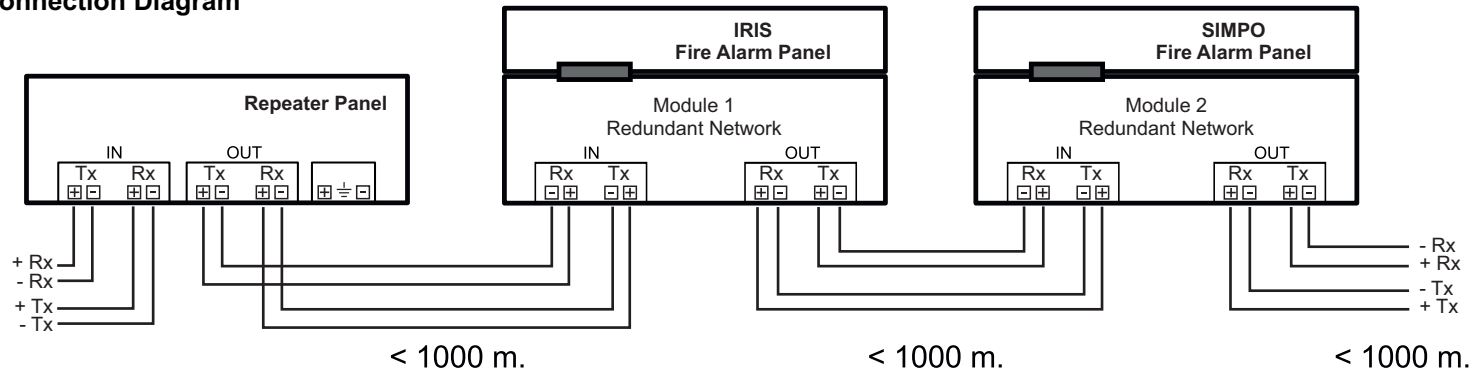

PCB Elements

- 1 - 24V DC Power supply
- 2 - RS485 interface
- 3 - LED indication for RS485 interface
 - Normal mode - blinking
 - Trouble mode - lighting on
- 4 - LAN interface
- 5 - USB interface
- 6 - Restore Defaults jumper
- 7 - Built-in battery
 - Jumper BTR must be set.
- 8 - Built-in sound buzzer

Technical Characteristics:

Power Supply: (24 ± 4) VDC
Max. consumption: 300mA
Communication - LAN/RS485

Twisted pair cable:
- Length - max. 1000m
(between repeater - fire panel)
- Cross Section - 0.5 - 2.5mm²

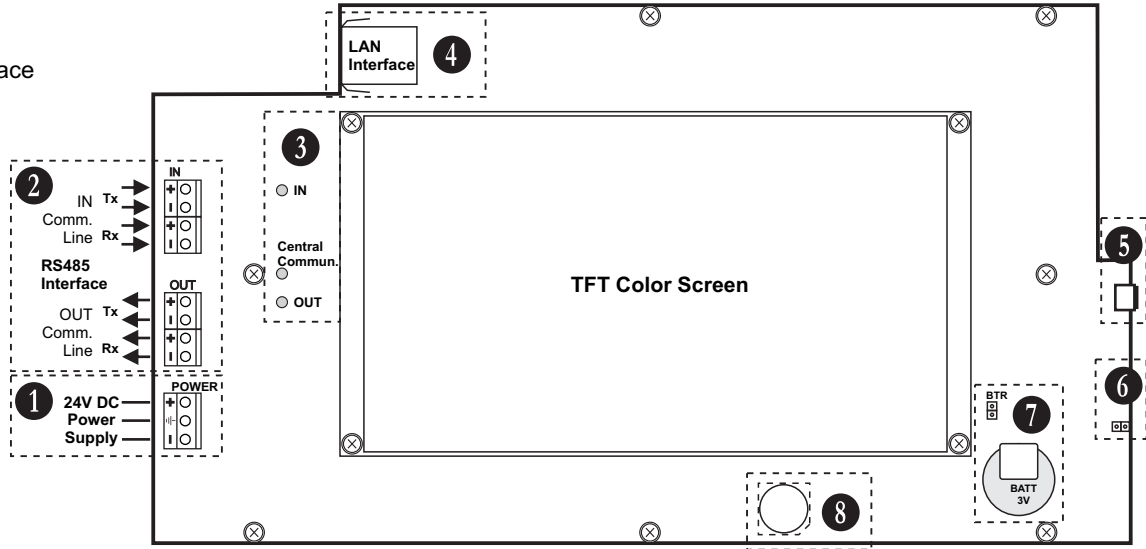

Connection Diagram

